

A close-up photograph of a person's hand resting on a brick wall. The hand is wearing a black wristwatch. The brick wall is under construction or renovation, with some mortar visible between the bricks. The background is a plain, light-colored wall.

UNIVERSITY OF MARYLAND  
**School of Architecture,  
Planning & Preservation**

Design Studio Final Reviews  
Fall 2019

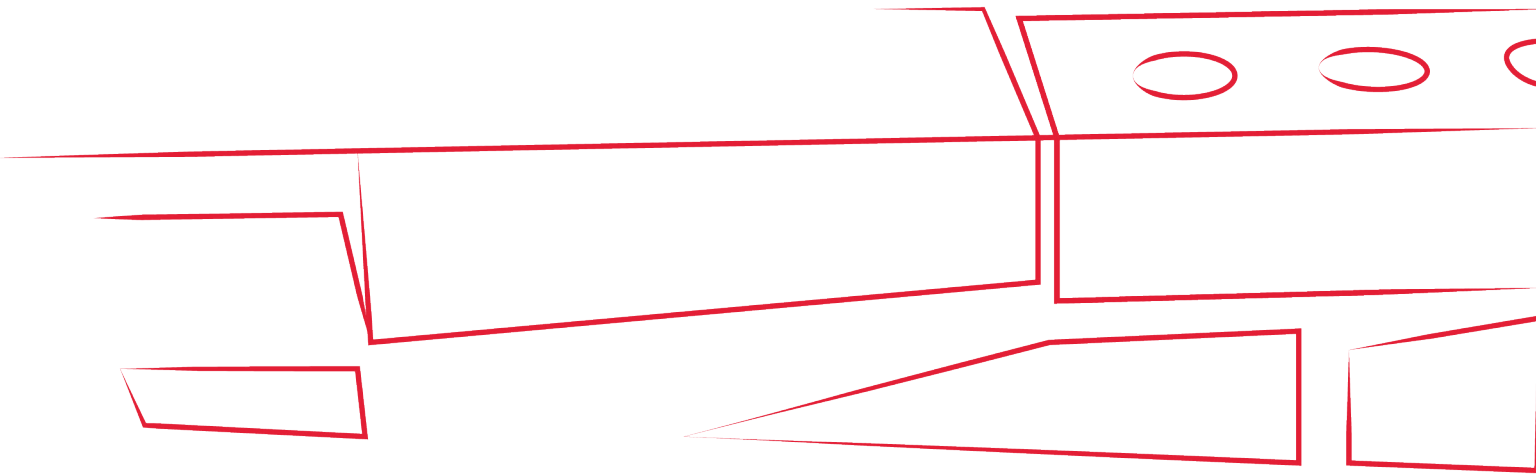

**5** Table of Contents

**ARCH 403 7** Center for Sustainable Innovation at the University of Maryland

**ARCH 406 9** A Cultural Destination for the C&O Transect

**ARCH 700 11** Urban Design in Two Worlds

**ARCH 600 13** Integrated Design Studio

**ARCH 401 15** Library Design

**ARCH 404 17** Hybrid Houses: A Conversation Between 3 Architects

**19** Sketches & Notes

All reviews take place from **2:00 - 6:00 PM**

**ARCH 403**                      **Location**

Rayya Newman                      1101  
Brittany Williams                      1103  
Eric Hurtt / Joshua Hill                      1127-25  
Marcus Cross                      Great Space and 1123

**Wednesday, December 4**

**ARCH 406**                      **Location**

Jamie Tilghman                      1105

**Wednesday, December 4**

**ARCH 700**                      **Location**

Matthew Bell                      ARCH 700 Studio  
Pablo Güiraldes  
Christian Calleri

**Thursday, December 5**

**ARCH 600**                      **Location**

Julie Gabrielli                      1101, 1103, 1105  
Amy Gardner                      Great Space

**Friday, December 6**

**ARCH 401**                      **Location**

Michael Abrams                      1101  
Danielle Alexander                      1103  
Douglas Crawford                      1105  
Joseph McKenley                      Great Space 3 and 1123  
Georgeanne Matthews                      Great Space 1 and 2

**Monday, December 9**

**ARCH 404**                      **Location**

Lindsey May                      1127-25

**Monday, December 9**



## ARCH 403      Center for Sustainable Innovation at the University of Maryland

The students in ARCH403 are designing their final required studio project as part of their BS in Architecture degree. Pedagogically, the studio has been focused largely on the integration of sustainable strategies, structure, and materiality into the design process. Over the second half of the semester, students have undertaken the design of a new Sustainable Innovation Center on campus located at the South Gate. Programmatically, the Center provides a public venue for the University to highlight sustainability measures implemented on campus, showcase sustainable research findings conducted by faculty and researchers, and exhibit the diverse artwork of environmental artists. The project affords students the opportunity to explore a building in the landscape and study issues of imageability, access, topography, environmental stewardship, structural integration, and building tectonics, among other things.



## ARCH 406

## A Cultural Destination for the C&O Transect

The final building design project for ARCH 406 will see the convergence of all of the previous design exercises and site analysis of the semester come together on a site adjacent the C&O canal near the confluence of the Canal and the Potomac River. The pedagogic themes of the semester: sustainable building practices and communities, resilience for sea level rise, defining urban borders and thresholds, the identity of civic institutions, sequence of civic and public spaces from exterior to interior community spaces, material selection and assembly, and structural concepts and material selection, and program definition and representation are set in a semester long engagement with closely related sites adjacent the Potomac river. The objective is to define a vibrant new destination on the C & O transect drawing on the convergence of previous design challenges at a variety of scales, culminating in the final design project.



Arch 700 focuses upon urban design problems varying in scale and in cultural context. The studio involves the participation of the visiting Kea Professor, Pablo Güiraldes and concentrates upon the development of knowledge in urbanism, building types, urban morphology and the relationship and pressures brought to bear upon existing sites by their cultural and physical histories. Students work alone and in groups and are responsible for the development of base documentation, historical research and design proposals.

The major semester assignment is the development of proposals for two sites: one, in suburban Washington, DC at the Largo Metro station in Prince George's County, MD; and another at the Canal San Fernando in greater Buenos Aires, Argentina. Emphasis is placed on plan strategies for each neighborhood, as well as strategies for the re-use/transformation of existing buildings, "placemaking" and phasing. Each proposal examines how a lower density neighborhood can be developed from the fragments of urban sprawl, new buildings, urban space and infrastructure, both the natural and the artificial.



## ARCH 600

## Integrated Design Studio

This fall, Integrated Design Studio challenged students with foundational theory about craft, meaning and materiality. Students explored the constructive intentionality of Greene and Greene, the monolithic rigor of Frank Lloyd Wright's Usonian houses, and modern layered wall sections informed by energy efficiency and sound building science.

The project is a visitor's center for Frank Lloyd Wright's Usonian Pope-Leighey House, on the grounds of Woodlawn Plantation in Alexandria, VA.

Study of and a visit to Wright's Pope-Leighey house in Arlington informed students' work to pick up where Wright left off. As always, the focus went beyond problem-solving to how today's aesthetic and functional demands could transform the theoretical architectural intentions embodied in the iconic houses of the early twentieth century.

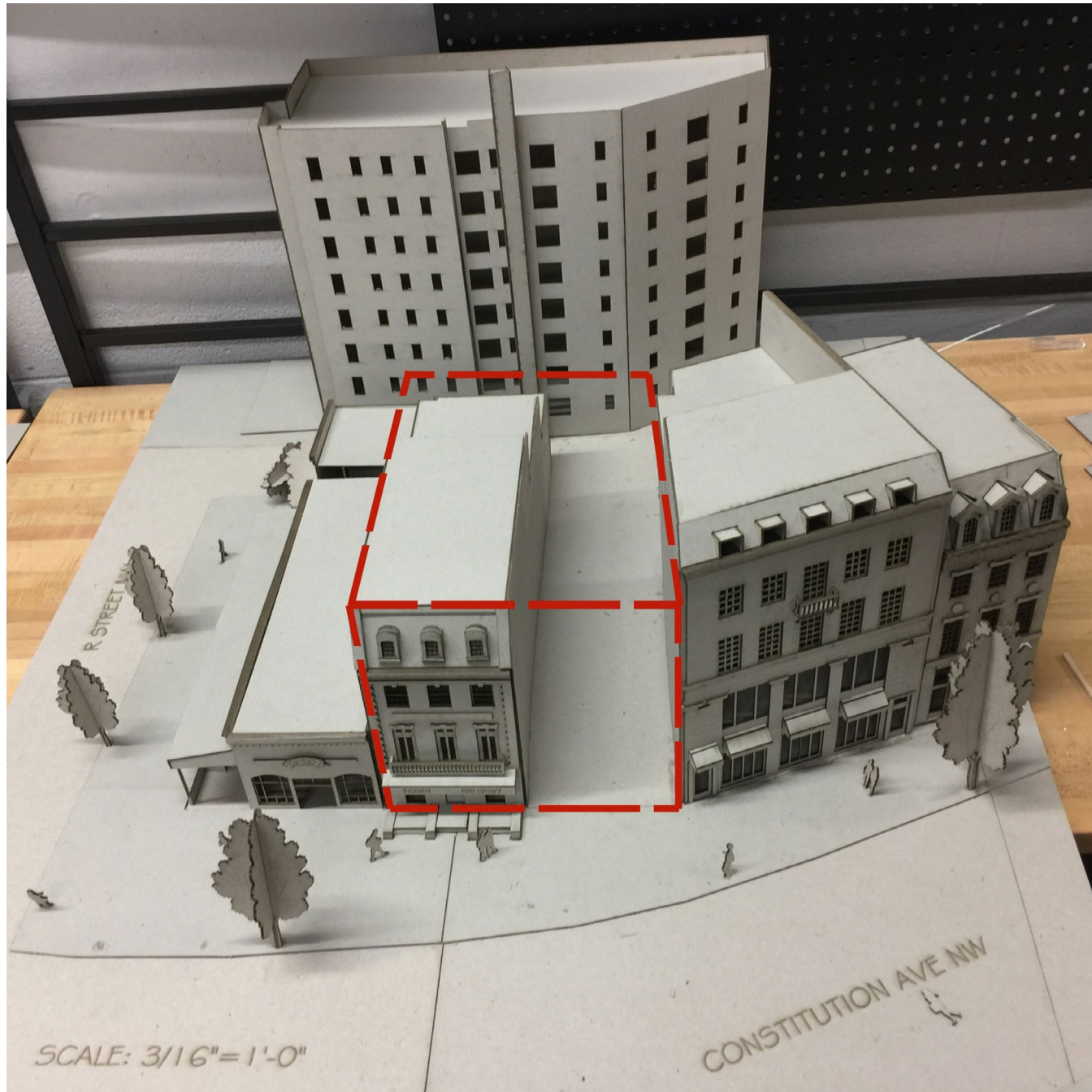

## ARCH 401

## Library Design

This final project is a culmination of the Level 1 experience, incorporating and developing the issues addressed throughout the year. Principles of procession and space making, functional organization, climate design, and room and façade design, are explored in an urban context. With regard to the public library, there has been a dramatic programmatic transformation from a building designed almost exclusively to house a collection of books and other research materials for public access, to a building which emphasizes its social role as a hub of self-learning and enquiry, as a meeting place for groups and individuals, and as a venue for talks and discussions about literature, ideas, professional developments, and even job opportunities.

The library is conceived to relate comfortably to the other buildings in DuPont Circle, yet have its own character and identity. Students are asked to develop a **narrative** or **story line** for the building as part of the process of establishing its character.

**ARCH401 | Michael Abrams, Danielle Alexander, Douglas Crawford, Joseph McKenley, Georgeanne Matthews**



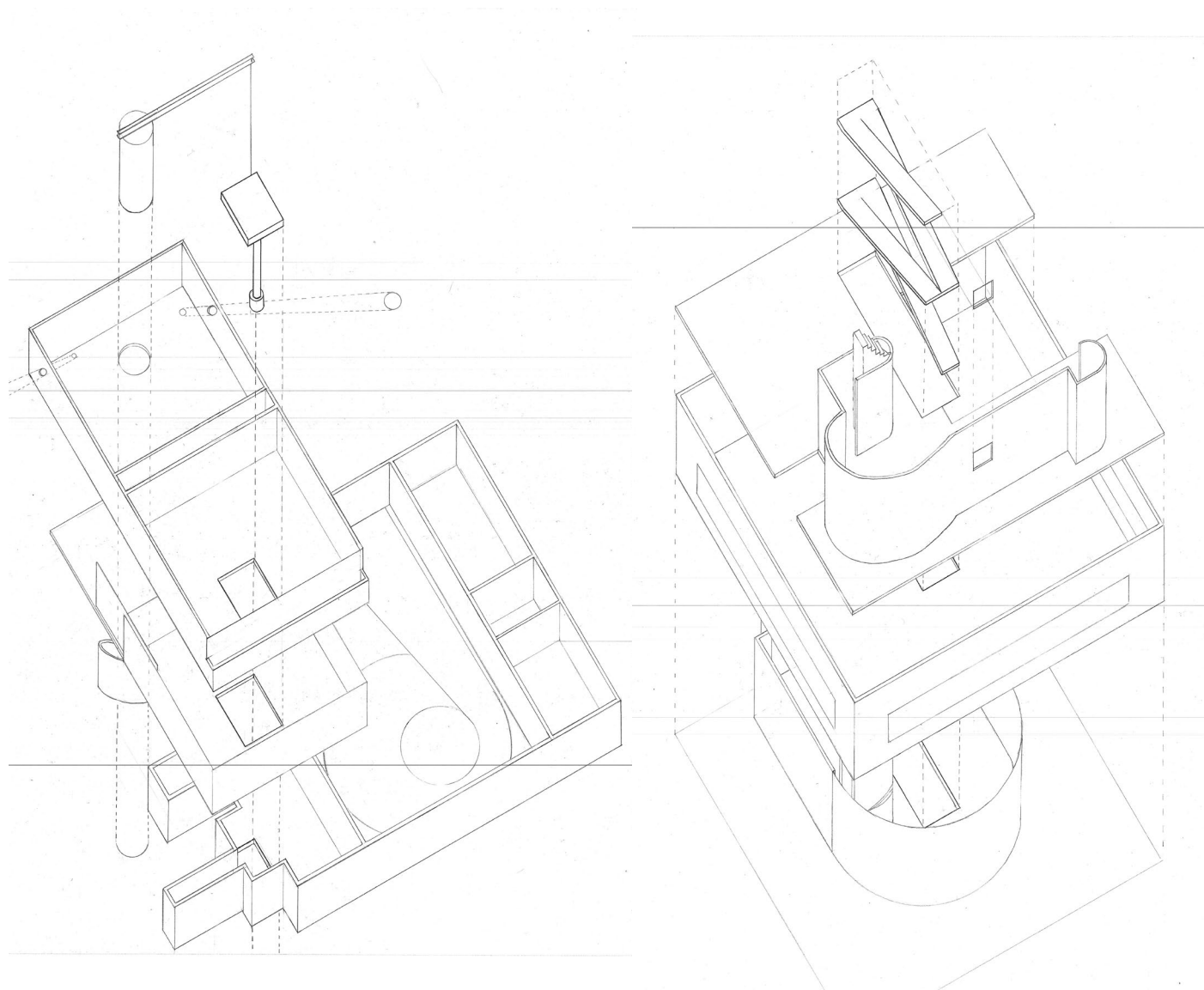

Cannibalizing two canonical houses, each student designed a single family house in Greenbelt, MD. Each house was conceived of as both a composite and critique of their two canonical houses.

Before starting their design project, each student was tasked with 1) understanding masonry brick veneer construction materially and conceptually and 2) a pair of historic dwellings anchored around themes central to a discussion of domesticity and architecture. Through drawing, diagramming, and modeling, each student took a deep dive into masonry veneer and their two precedents to distill the organizing principles and design gestures before beginning their design work. Exploded axons played a large representational role in this studio.







SCHOOL OF  
ARCHITECTURE,  
PLANNING & PRESERVATION

Maryland's Built Environment School